

# \$1,499,999 - On Highway 12 Rural Lacombe County, Rural L

MLS® #A1096176

**\$1,499,999**

0 Bedroom, 0.00 Bathroom,  
Commercial on 0 Acres

Wildrose Commercial Park, Rural Lacombe County, Alberta

14.43 ACRES - HIGHWAY COMMERCIAL, INVESTORS alert!!! Approved for Branded Gas Station, Franchise Food chain.....right on Highway #12 and Highway #2 at the entrance of Wild Rose Commercial Park. Excellent site location. Property is good for long term INVESTMENT / INVESTORS / Development. Property will be well suited for Hotel/Motel, Truck Stop/Card lock, Restaurant, Fast Food or Truck/car/RV Wash. Realtor has interest in the Property. Lacombe county has installed the water the sewer to the property line and will Service each lot at an additional cost Under Bylaw no 1253/17.

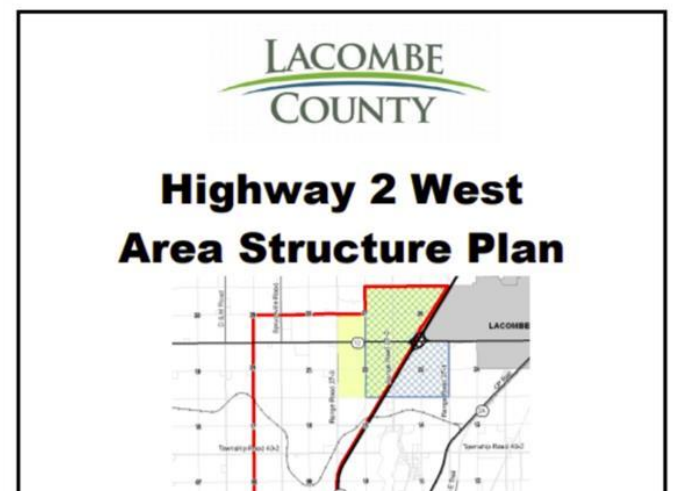
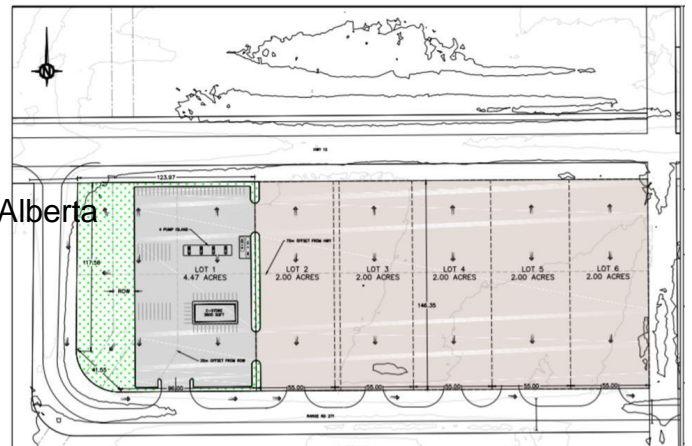

Highway 2 West Area Structure Plan: Commercial Buffer Zone

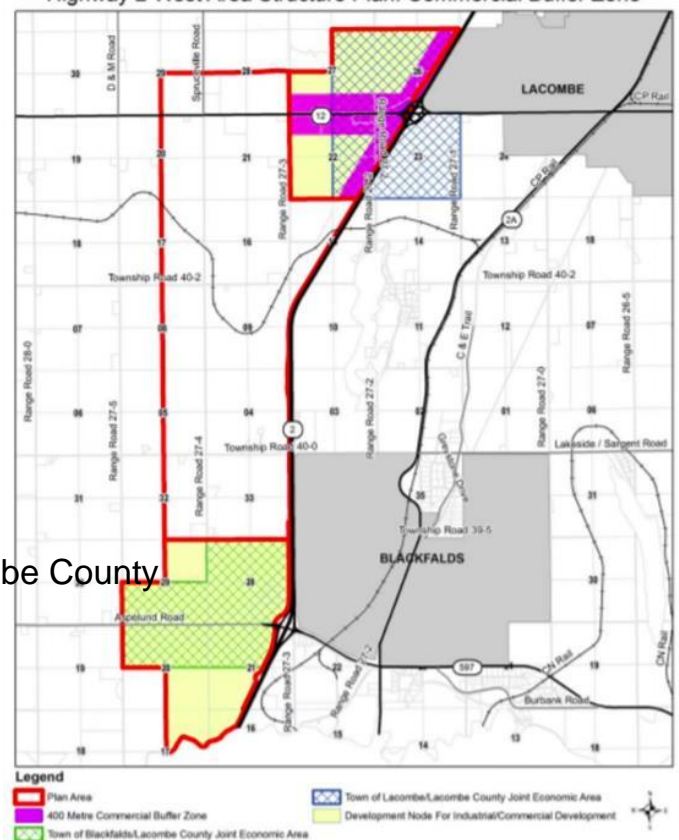

Figure 2

## Essential Information

MLS® #	A1096176
Price	\$1,499,999
Bathrooms	0.00
Acres	0.00
Type	Commercial
Sub-Type	Business
Status	Active

## Community Information

Address	On Highway 12 Rural Lacombe County
Subdivision	Wildrose Commercial Park
City	Rural Lacombe County
County	Lacombe County
Province	Alberta

Postal Code T0K 0J0

### **Additional Information**

Date Listed April 20th, 2021

Days on Market 54

Zoning FUTURE HIGHWAY COMMERCIAL

### **Listing Details**

Listing Office Courtesy Of Charles Dhami Of CENTURY 21 BRAVO REALTY

MLS listings provided by Pillar 9&trade;. Information Deemed Reliable But Not Guaranteed. The information provided by this website is for the personal, non-commercial use of consumers and may not be used for any purpose other than to identify prospective properties consumers may be interested in purchasing.